



GREEN BUILDING



BUTTERFLY HABITAT

RENOVATION TIMELINE	
June - July 2011	Museums move to temporary locations Center closed to the public July 31, 2011
August 1, 2011	Renovations to main building begin
October 2012	Museums move back to Center
November 2012	Center in the Square re-opens
Spring 2013	Grand Opening celebrations
Dates are subject to change	

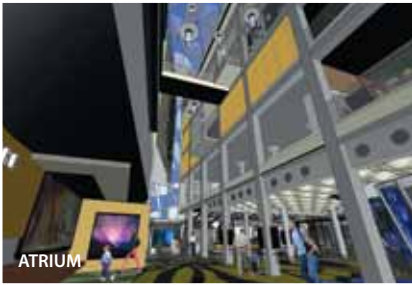

ATRIUM

**REFURBISHED EXTERIOR** Center's street level appearance and visibility to the Market Square will be improved, the atrium will be redesigned and reprogrammed, a green roof feature that includes a butterfly habitat, spaces throughout both buildings will be reconfigured and connected, and most of the systems and mechanicals will be upgraded. Exterior refurbishments will focus on recapturing Center in the Square's historic facades. Replacing the transoms and cornices will restore the character of the building and the cherished history of the Market Square. A new ticket booth will serve both walk-up customers from the street and allow for sales in the interior atrium.

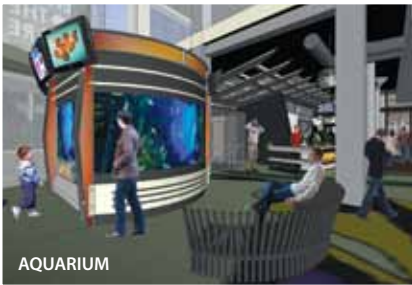

AQUARIUM

**REDESIGNED ATRIUM** The redesigned, interactive, and open atrium will connect all visitors to the exciting exhibits housed in the museums above. In order to bring the vibrancy of the market into the atrium, the glass wall that faces the Market Square will have sections that slide open. This change will allow the atrium to be a wonderful event space that may be used by beneficiary organizations and other groups.

The new Center will have a breathtaking 5,500-gallon living coral-reef aquarium that will hold 250 colorful marine fish and 150 assorted live soft and stony corals, as well as three smaller aquariums, two holding jellyfish and one holding seahorses.



SCIENCE MUSEUM

**The Science Museum of Western Virginia** is a large beneficiary of reconfigured space, and they plan to significantly change and radically enhance the way it serves the community. Plans include not just reinventing exhibit galleries, but also the entire Museum and its connecting spaces, classes, and programs. The building itself will convey that a visitor has entered an exciting, vibrant center for learning. The Science Museum's reinvention will establish the *Healthy Bodies*, *Healthy Earth*, and the *How It Works* galleries, along with connecting spaces.

**The History Museum & Historical Society of Western Virginia** will benefit from expanded space with superior climate control necessary to display, store and protect its collection of great historical value.



MILL MOUNTAIN THEATRE

**The Harrison Museum of African American Culture** will become the newest of Center's beneficiary organizations. They will be able to expand their audience, increase its permanent collection, and bring in more exhibits.

**Mill Mountain Theatre** is currently reinventing its productions to reemerge stronger than ever in the newly renovated Center in the Square. A welcoming and patron-friendly lobby space and an efficient, public-oriented box office are just the first of many steps to make a wonderful evening at the Theatre even more magical.

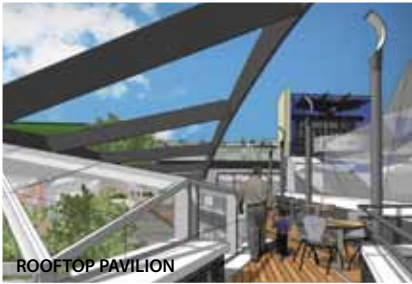

ROOFTOP PAVILION

**GREEN ROOFTOP** One of the most exciting features of Center's plans is a new rooftop. A dining and entertainment experience is being planned on the roof. The latest green roof and energy harnessing technologies will be incorporated into the rooftop experience for both operational effectiveness and as educational exhibits.

Improved environmental strategies and systems will be installed throughout the building. Center in the Square will be not only a model for practicing environmentally sound behavior, it will teach others how to do so as well.

